



# KRISHNA HARE ASHIYANA

P R E M I U M   H O U S I N G

FULLY AIR-CONDITIONING APARTMENT



A HOME  
MADE FOR  
YOU AND  
YOURS.

THE BEST  
SMART  
PROPERTY  
THAT VRINDAVAN  
HAS TO OFFER

HARE  
KRISHNA  
LAKSHMI  
PREMIUM HOUSING





# AN IDYLIC LOCATION

## RUKMANIVIHAR, VRINDAVAN



A thriving Religious city, Vrindavan, better known as Birth Place of Lord Krishna.

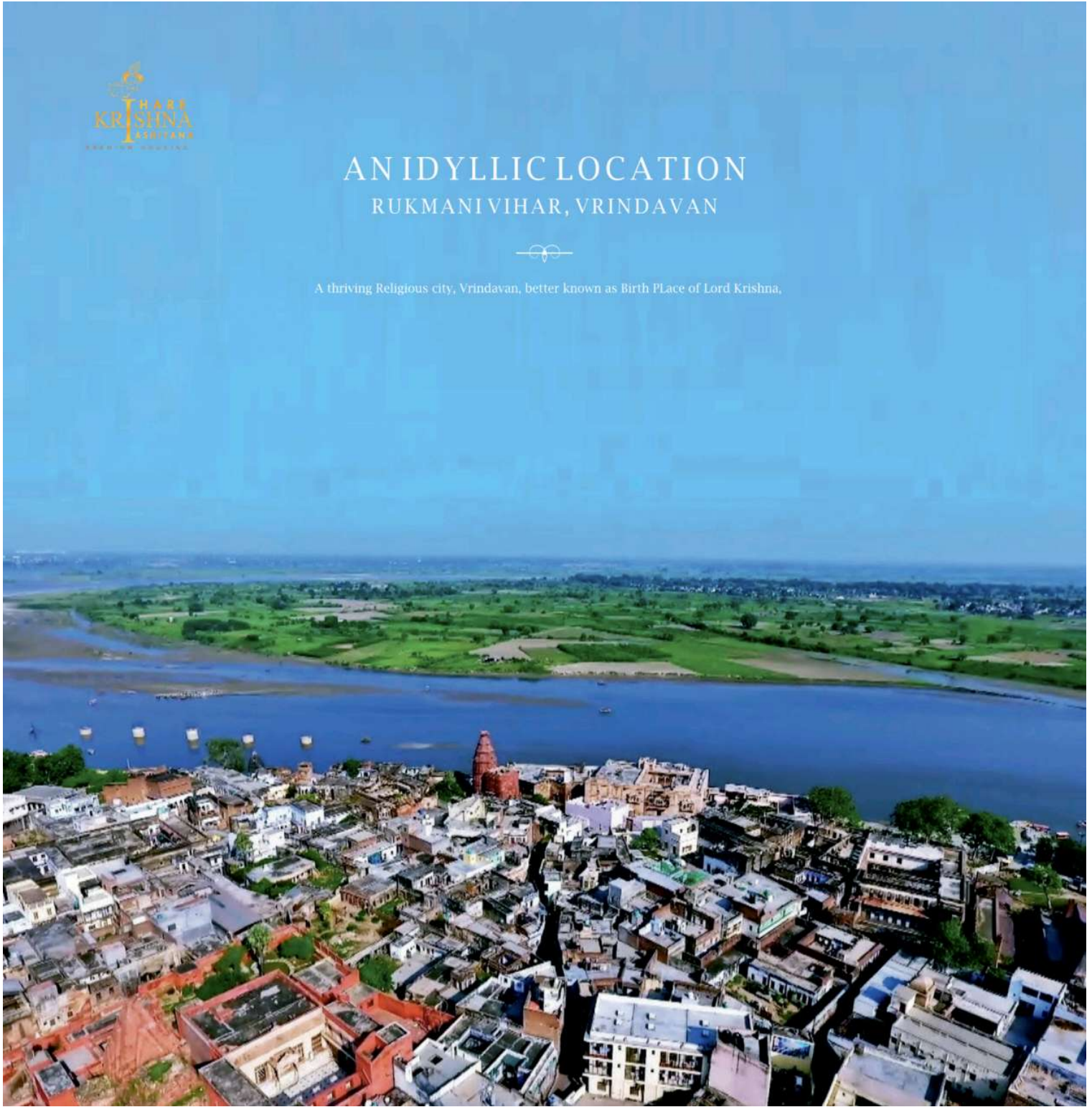



A MELTING POT OF GLOBAL EXCLUSIVES

ON RUKMANI VIHAR



मेशो वृन्दावन



RUKMANI VIHAR

Most Prime Location of Mathura Vrindavan District

Located With Largest Shopping Mall of Vrindavan 7 Star Hotels Like Taj, Nidhivan Sarovar Portico, Royal Bharti, Brijwashi



PROPERTY WITHIN 500 MTR.  
FROM HARE KRISHNA ASHIYANA



**OMAXE COMMERCIAL**

Largest Shopping Mall of Vrindavan with Shops, food Court, Multiplex, and Kids fun Zone



**BEST WESTERN**

A luxury hotel located in the heart of Rukmani Vihar Vrindavan



**NIDHIVAN SAROVAR PORTICO**

Premium Luxury Hote Rukmani Vihar, Vrindavan



**ROYAL BHARTI**

Premium Hotel Rukmani Vihar, Vrindavan



**UPCOMING HOTEL TAJ**

# LOCATION MAP





CONTROL YOUR HOME FROM ANYWHERE

## FULL SMART AUTOMATION APARTMENT

ACCESS ANYWHERE, ANY TIME  
YOUR SECURITY, LIGHTING, APPLIANCE

HARE  
KRISHNA  
ASHIYANA  
PREMIUM HOUSING



LOCATED IN THE MOST WELL-CONNECTED AREA OF VRINDAVAN WITH THE BEST VIEWS.  
HARE KRISHNA ASHIYANA IS THE PLACE TO SETTLE IN WITH YOUR LOVED ONES, BUILT  
WITH FUTURE-FORWARD DESIGNS AND LUXURY AT ITS HEART THAT'S BOUND TO IMPRESS  
YOU AND YOURS

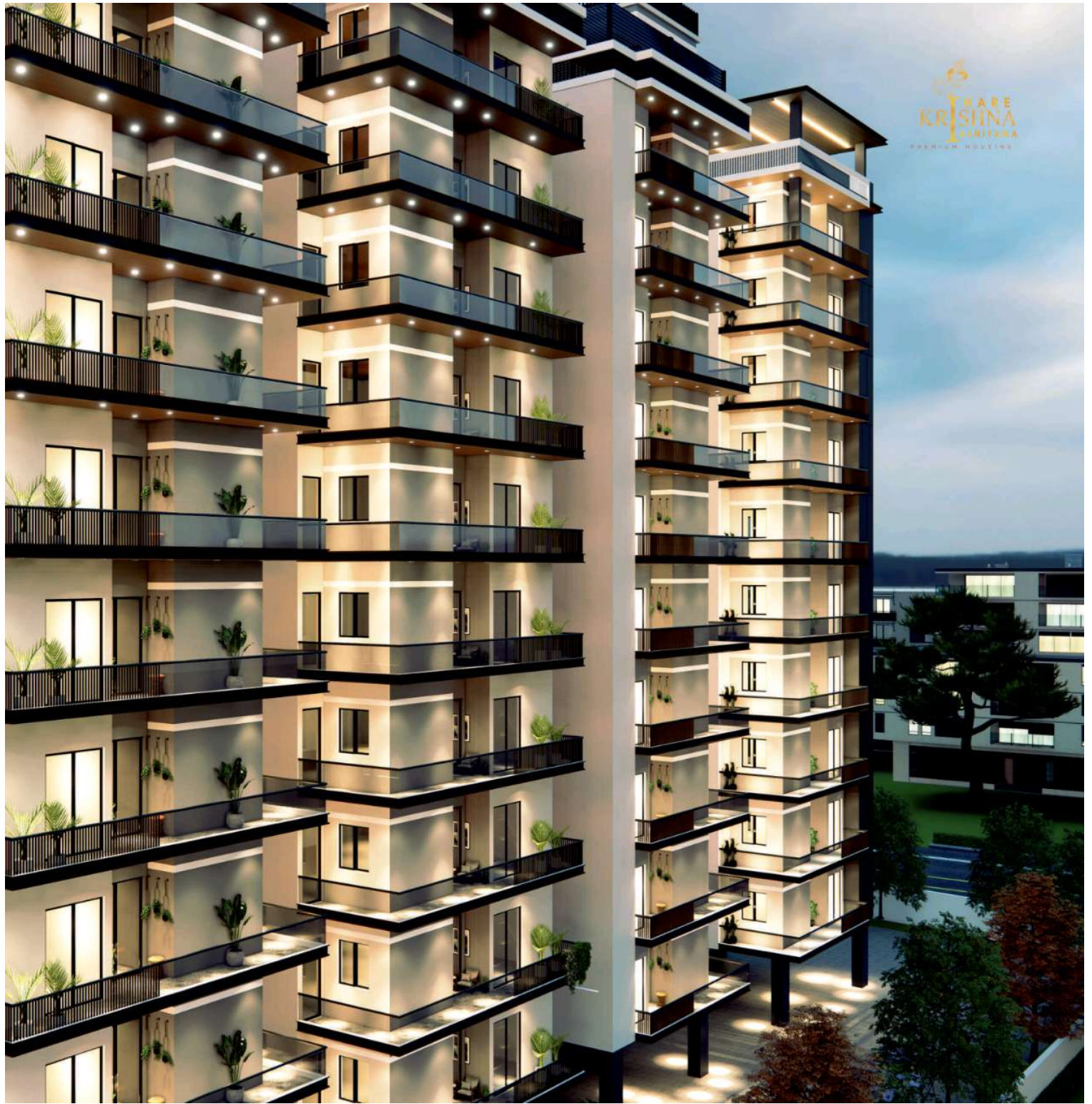

SHREE  
KRISHNA  
PREMIUM HOUSING



# A LEGACY IS BORN





## TERRACE GARDEN WITH SEATING



TERRACE GARDEN IS THE PERFECT SPACE FOR FAMILIES,  
AND ALL THOSE WHO WANT  
TO IMMERSE THEMSELVES IN A WORLD OF COLOUR AND BEAUTY.



## LIVE LIFE TO THE FULLEST.

INDOOR SWIMMING POOL

BADMINTON COURT

OUTDOOR GYM

KIDS PLAY AREA

CRICKET NET

PICNIC AREA

GREEN TERRACES

WALKING TRAIL

SURFACE PARKING

PRIVATE PODIUM

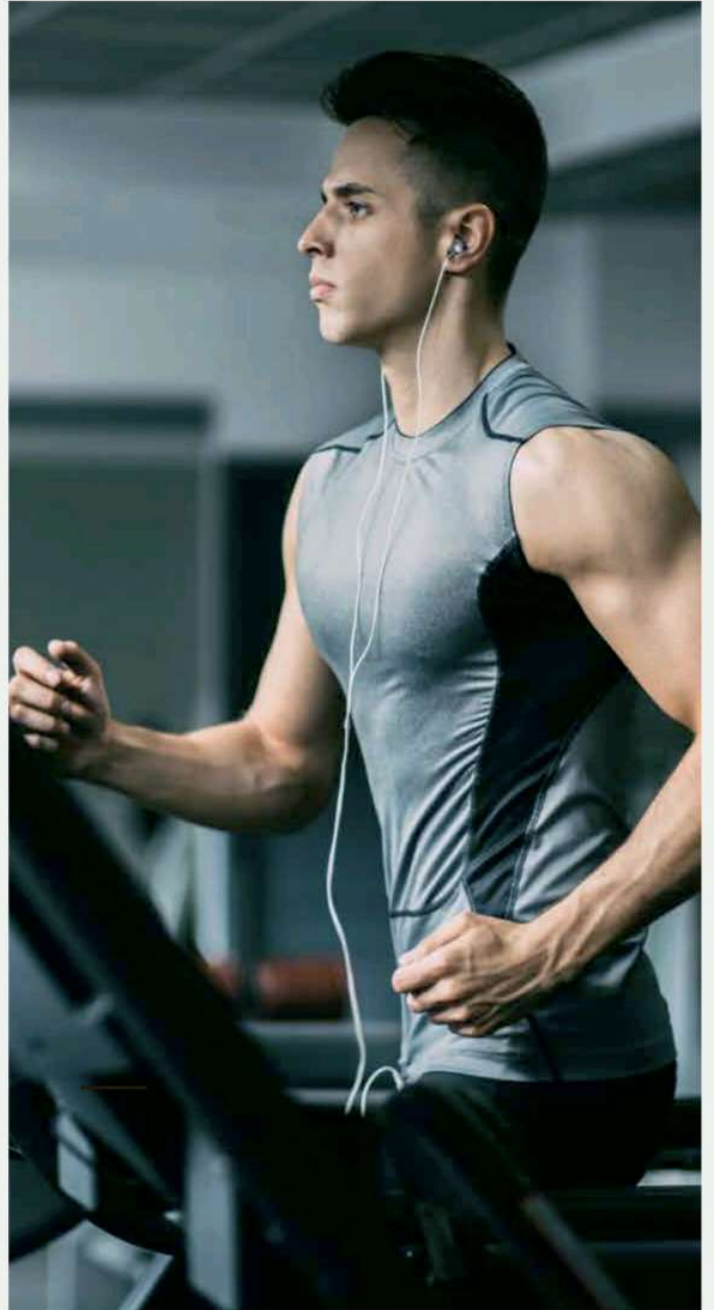

  
HARE  
KRISHNA  
PREMIUM HOUSING



HARE  
KRISHNA  
ASMITARA  
PREMIUM HOUSING



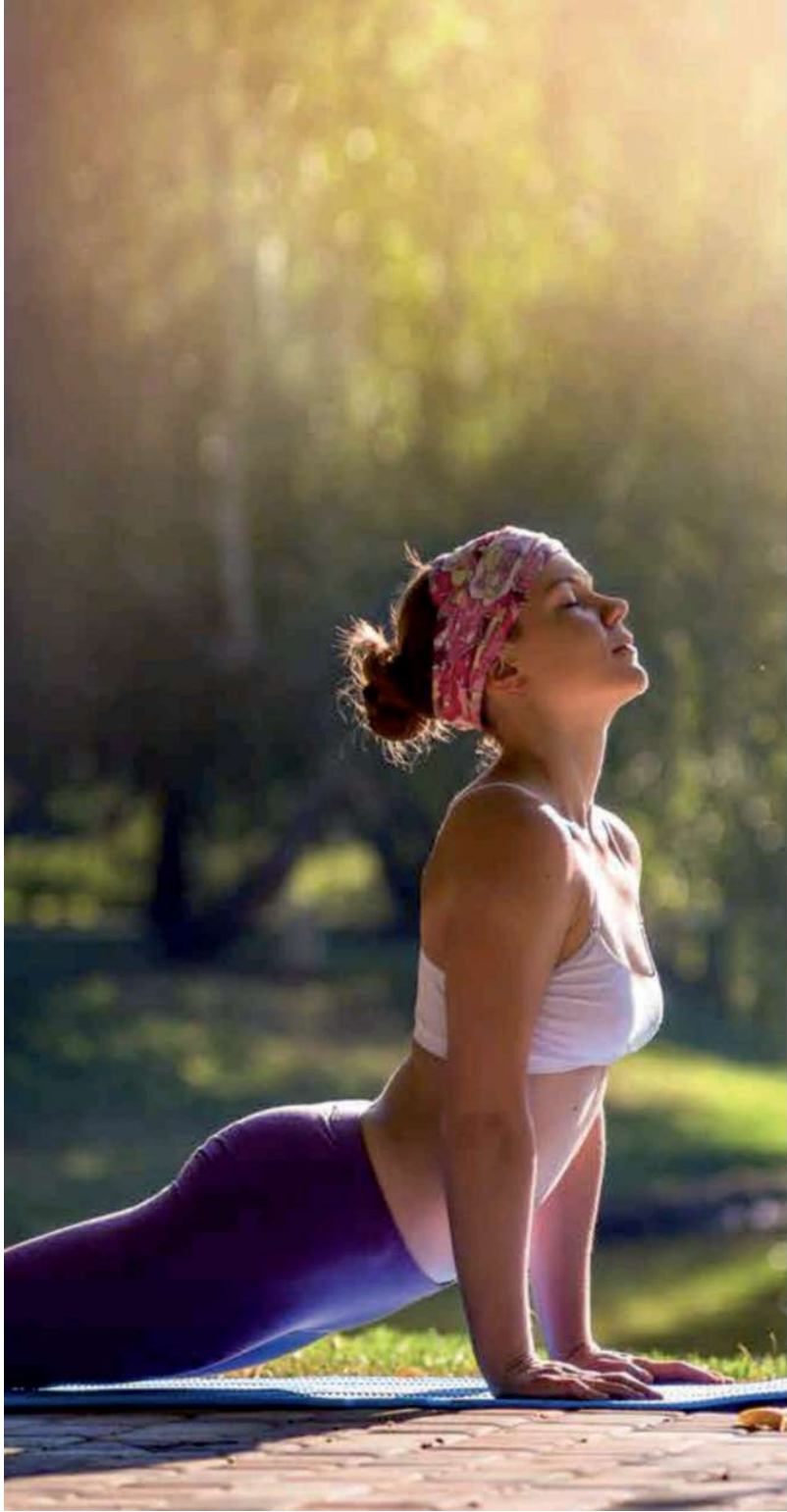

  
**HARE  
KRISHNA**  
ASHIYANA  
PREMIUM HOUSING

**MAKE  
EVERY DAY,  
A FUN DAY.**

# EXPLORE FUN OUTDOOR ACTIVITIES



BADMINTON COURT



SWIMMING POOL



KIDS PLAY AREA



CRICKET PITCH



## CURATED FOR THE GLOBAL CONNOISSEUR



Our unit plans are designed keeping in mind the best standards in the world.  
Every square inch is developed with scrupulous attention to detail for the highest level of luxury.



Luxurious 3 bed residences with large balconies

No common walls, creating a sense of space and freedom

UNCOVER  
A LIFE OF  
LUXURIOUS  
COMFORT



THE ROOMS ARE MADE  
KEEPING THE LUXURIOUS  
AESTHETICS IN MIND.  
ONE THAT GIVES YOU AND  
YOURS THE COMFORT  
THAT'S BOUND TO MAKE  
THEM HAPPY.

**STUNNING  
KITCHEN SPACE  
THAT'S MADE  
ESPECIALLY FOR  
YOU AND YOURS**



**WITH OUR KITCHEN, YOU GET BOTH  
BEAUTY AND FUNCTIONALITY.  
STATE-OF-THE-ART DESIGN TO ENSURE  
YOUR HOME FEATURES A FLAWLESS  
KITCHEN THAT LASTS A LONG TIME**

## A VIEW TO REMEMBER

  
**HARE  
KRISHNA  
ASHIYANA**  
PREMIUM HOUSING



BE IT A READING NOOK,  
A SPOT FOR GET-TOGETHER  
OR FOR A QUIET EVENING,  
WITH A SPECTACULAR VIEW,  
OUR BALCONY MIGHT JUST  
BECOME YOUR FAVORITE  
PLACE IN THE HOUSE.



HARE  
KRISHNA  
PREMIUM HOUSING



# MASTERPLAN

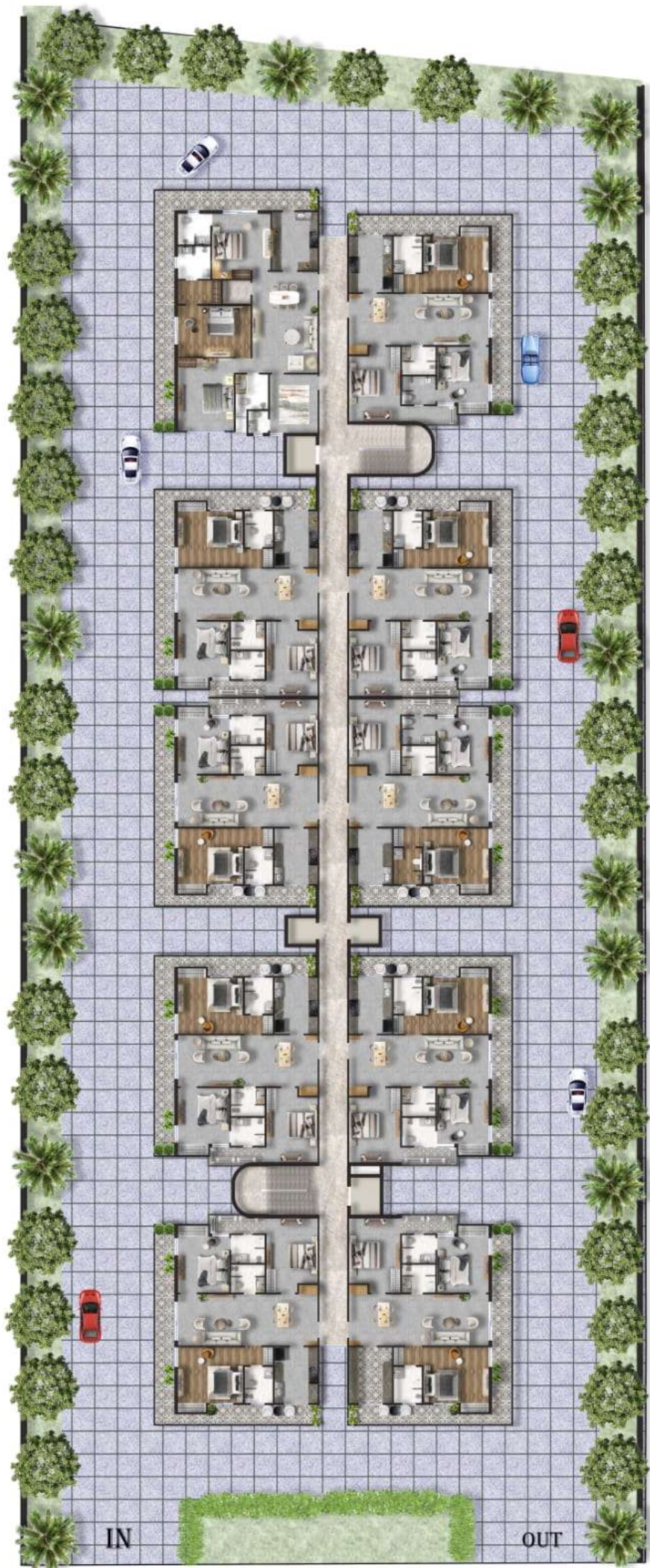

IN

OUT





## **PRICE LIST**

<b>TYPE</b>		<b>Basic Cost ( Including Open Car Parking, Amenities Membership, EDC &amp; IDC,FFC )</b>
3BHK	1925	Rs 1,88,50,000
4BHK	2278	Rs 2,23,00,000

### **EXTRA CHARGES**

Wood Work (include Modular Kitchen, 3 Bedroom Almirah and 3 TV Cabinets (Optional)	3BHK Rs 5,50,000/-
	4BHK Rs 6,50,000/-

### **PLC (Preferred Location Charges)**

Rs 400/- Per sqft on Unit No. 1 and 10

Rs 300/- Per Sqft on Unit No. 6

GST & Stamp Duty as per Govt.

## **Construction Link Payment Plan**

1	Booking Amount	10 Lakh
2.	With in 30 Days	Complete 20%
3.	Start of Construction	10%
4.	Completion of Foundation Work	10%
5.	Casting of Ground Floor Slab	10%
6.	Casting of 2nd Floor Slab	7%
7	Casting of 5 <sup>th</sup> Floor Slab	7%
8	Casting of 8 <sup>th</sup> Floor Slab	6%
9	Casting of 11 <sup>th</sup> Floor Slab	5%
10	Casting of 14 <sup>th</sup> Floor Slab	5%
11	Completion of Internal POP	5%
12	Completion of Flooring	5%
13	Completion of External Putty	5%
14	On Offer of Possession	5%

- All Chq in Favour of “ Hare Krishna Ashiyana Pvt. Ltd.”

# SPECIFICATIONS



## STRUCTURE

- WALL** • RCC framed structure designed for seismic resistance
- TREATMENT** • Anti-termite treatment under foundation and along the external perimeter

## PAINTING

- EXTERIOR** • Cement plaster with exterior weather shield paint
- INTERIOR** • Apartment – Putty with Oil Bond Distemper (Asian paints or equivalent)
- Lobby – Cement plaster with Oil Bond Distemper (Asian paints or equivalent)
- False ceiling – common areas

## FLOORING

- Living, dining, bedrooms, kitchen and walkways Vitrified tile
- Sit-out and balconies – Rustic ceramic tiles
- Toilet and utility – Anti-skid ceramic tiles and wall tiles up to ceiling
- Skirting – Matching floor tiles up to 4" height

## JOINERY

- DOORS** • Main door – Solid flush doors laminated
- Bedroom doors – Solid flush doors laminated
- Toilet doors – Flush doors laminated
- WINDOWS** • UPVC or Anodized aluminum windows
- HARDWARE** • Locks (Godrej or equivalent)

## KITCHEN/UTILITY

- DADO** • Glazed decorative ceramic tile up to 2' above cooktop (Kajaria or equivalent)
- SINK** • Designer series SS single bowl – Matt finish

## ELECTRICAL

- WIRING** • Copper wiring in PVC concealed conduits
- Split Ac In All Rooms And Drawing Rooms

## WATER SUPPLY

- ISI certified CPVC water lines and UPVC sewer lines

## PLUMBING & SANITARY

- EWC** • Wall mounted with concealed flush tank (Jaquar or equivalent)
- WASH BASIN** • Wash basin ( Jaquar or equivalent)
- CP fittings (Jaquar or equivalent) in toilets, utility and kitchen

## ELEVATORS

- High speed elevators with power back up

## SECURITY SYSTEM

- Boom barrier at main entrance

## FEATURES

- WI-FI/DTH connectivity
- 100% power back up for common areas
- Power back up for all fans, lights
- Visitors' car parking

## AMENITIES

- Swimming pool
- Indoor play area
- Health club
- Gym and changing rooms
- Yoga & meditation
- Sky garden
- Office space for amenities

## GREEN FEATURES

- Adequate day lighting and fresh air
- Waste water recycling
- Rainwater harvesting
- Water meters and energy meters

## ABOUT US



HARE KRISHNA HOMES has been a trusted developer in North India

The house of HARE KRISHNA HOMES brings together the skills and acumen of legends in the field of business and the most respected names in North India real estate industry.

We are setting new standards for quality creation in homes that truly reflects our brand philosophy – 'Adding Life to Living'.

Having executed over 10 projects in the Different city, HARE KRISHNA HOMES have a dedicated team of in-house professionals, consultants and architects who provide the basis for unparalleled quality of construction, and timely delivery of projects.

ADDING  
LIFE TO LIVING!



# HARE KRISHNA ASHIYANA

EPOCH REALTECH PVT. LTD

GH-3, RUKMANI VIHAR PHASE -1, VRINDAVAN MATHURA



UPRERAPRJ424528/11/2024  
[www.up-rera.in](http://www.up-rera.in)

Disclaimer: The contents provided in this brochure are intended for informational purposes only and are not intended to constitute an offer or solicitation. We reserve our right to change or modify any information, material, data etc. Customers are responsible for seeking advice of professionals, as appropriate regarding the information, opinions, advice or contents pertaining to the property and its development, the details of which are set out in the brochure. We make no representations and disclaim all warranties, whether express, implied, or statutory, including but not limited to warranties as to accuracy, reliability, usefulness, completeness, merchantability, or witness of information for any particular purpose, non-infringement and any damages ensuing thereby.